

# DS-2CD2122F-I(S)(W) (2.0MP)

# DS-2CD2132F-I(S)(W) (3.0MP)

## IR Fixed Dome Network Camera

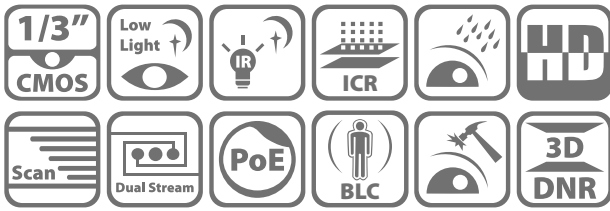

### Key features

- 2MP / 3MP high resolution
- HD real-time video
- 3D DNR & DWDR & BLC
- IR LEDs: up to 30m
- IP66
- Vandal-proof
- PoE
- Onboard storage (up to 64GB)
- Wi-Fi optional

### Dimensions

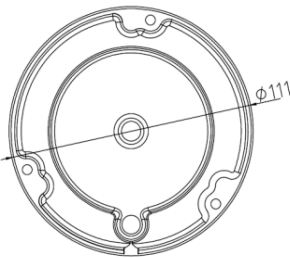
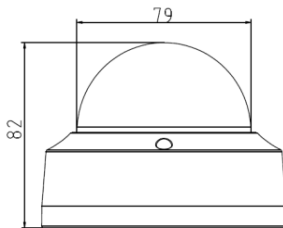

### Available models

2.0MP:

DS-2CD2122F-I, DS-2CD2122F-IS,  
DS-2CD2122F-IW, DS-2CD2122F-IWS

3.0MP:

DS-2CD2132F-I, DS-2CD2132F-IS,  
DS-2CD2132F-IW, DS-2CD2132F-IWS

\* 1.3MP model is also available -- DS-2CD2112F-I

\* -S: Audio I/O interface, Alarm I/O interface.

-W: Built-in Wi-Fi

	DS-2CD2122F-I(S)(W)	DS-2CD2132F-I(S)(W)
<b>Camera</b>		
Image sensor	1/3" Progressive Scan CMOS	
Min. illumination	0.01 lux@F1.2, AGC ON, 0 lux with IR	0.07Lux @F1.2, AGC ON, 0 lux with IR
Shutter time	1/3s ~ 1/100,100s	
Lens	4mm @ F2.0 (2.8mm, 6mm optional) Angle of view: 98.5°(2.8mm), 79°(4mm), 49°(6mm)	4mm @ F2.0 (2.8mm, 6mm optional) 2048 × 1536: Angle of view: 86°(2.8mm), 70°(4mm), 43.3°(6mm) 1920 × 1080: Angle of view: 98.5°(2.8mm), 79°(4mm), 49°(6mm)
Lens mount	M12	
Angle adjustment	Pan: 0° ~ 355°, Tilt: 0° ~ 65°, Rotation: 0 ~ 360°	
Digital noise reduction	3D DNR	
Wide dynamic range	Digital WDR	
Day & night	IR cut filter with auto switch	
<b>Compression Standard</b>		
Video compression	H.264 / MJPEG	
H.264 codec profile	Main profile	
Bit rate	32 Kbps ~ 16 Mbps	
Dual stream	Yes	
<b>Image</b>		
Max. Image Resolution	1920 × 1080	2048 × 1536
Frame rate	50Hz: 25fps (1920 × 1080), 25fps (1280 × 720) 60Hz: 30fps (1920 × 1080), 30fps (1280 × 720)	50Hz: 20fps (2048 × 1536), 25fps (1920 × 1080), 25fps (1280 × 720) 60Hz: 20fps (2048 × 1536), 30fps (1920 × 1080), 30fps (1280 × 720)
Image settings	Saturation, brightness, sharpness, contrast, sharpness adjustable through client software or web browser	
BLC	Yes, zone configurable	
ROI	Yes, up to 3 configurable areas	
<b>Network</b>		
Network storage	Local storage: Built-in Micro SD/SDHC/SDXC card slot, up to 64 GB ; NAS	
Alarm trigger	Face detection, line crossing detection, intrusion detection, scene change detection,	
Protocols	Motion detection, Dynamic Analysis, Tampering alarm, Network disconnect, IP address conflict, Storage full, Storage error	
System compatibility	TCP/IP, ICMP, HTTP, HTTPS, FTP, DHCP, DNS, DDNS, RTP, RTSP, RTCP, PPPoE, NTP, UPnP, SMTP, SNMP, IGMP, 802.1X, QoS, IPv6, Bonjour	
General functionalities	ONVIF, PSIA, CGI, ISAPI	
General function	User Authentication, Watermark	
Interface	Flickerless, dual stream, heartbeat, mirror, password protection, watermark	
Communication Interface	1 RJ45 10M/100M Ethernet interface	
<b>Wi-Fi Specification (Only for -W model)</b>		
Wireless Standards	IEEE802.11b, 802.11g, 802.11n Draft	
Frequency Range	2.4 GHz ~ 2.4835 GHz	
Channel Bandwidth	20/40MHz Support	
Protocols	802.11b: CCK, QPSK, BPSK ; 802.11g/n: OFDM	
Security	64/128-bit WEP, WPA/WPA2, WPA-PSK/WPA2-PSK, WPS	
Transmit Output Power	11b: 17±1.5dBm @ 11Mbps ; 11g: 14±1.5dBm @ 54Mbps ; 11n: 12.5±1.5dBm	
Receive Sensitivity	11b: -90dBm @ 11Mbps (Typical) ; 11g: -75dBm @ 54Mbps (Typical) ; 11n: -74dBm (Typical)	
Transfer Rates	11b: 11Mbps ; 11g: 54Mbps ; 11n: up to 150Mbps	
Wireless Range	Outdoor: 200m, Indoor: 50m ; *The performance varies based on actual environment.	
Wireless Standards	IEEE802.11b, 802.11g, 802.11n Draft	
<b>General</b>		
Operating conditions	-30 °C ~ 60 °C (-22 °F ~ 140 °F) ; Humidity 95% or less (non-condensing)	
Power supply	12V DC ± 10% ; PoE (802.3af)	
Power consumption	Max. 5 W (Max. 7 W with IR cut filter on)	
Impact protection	IEC60068-2-75Eh, 20J; EN50102, up to IK10	
Ingress protection	-W: En50102, up to IK8	
IP66		
IR range	30 meters	
Dimensions	Φ111 × 82 (4.4" × 3.2")	
Weight	500g (1.1 lbs)	